

- NOTES:
- GENERAL REQUIREMENTS PER 9900000.
  - MARK PART NUMBER, J96566-000, IN LOCATION SHOWN USING .125 CHARACTER HEIGHT. USE MECHANICAL ENGRAVING OR LASER MARK.
  - MATERIAL: ALUMINUM  
TYPE: 6061-T6

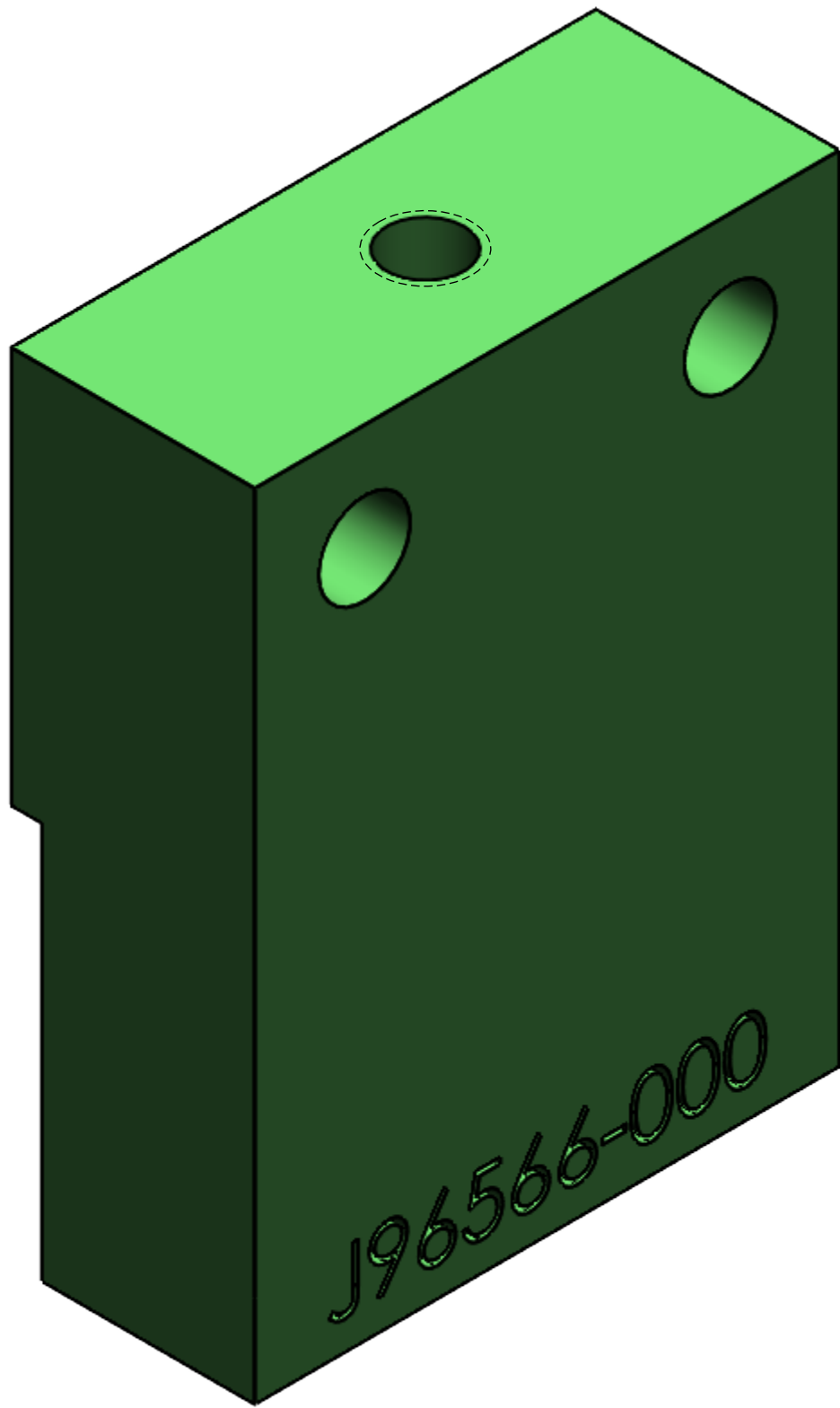
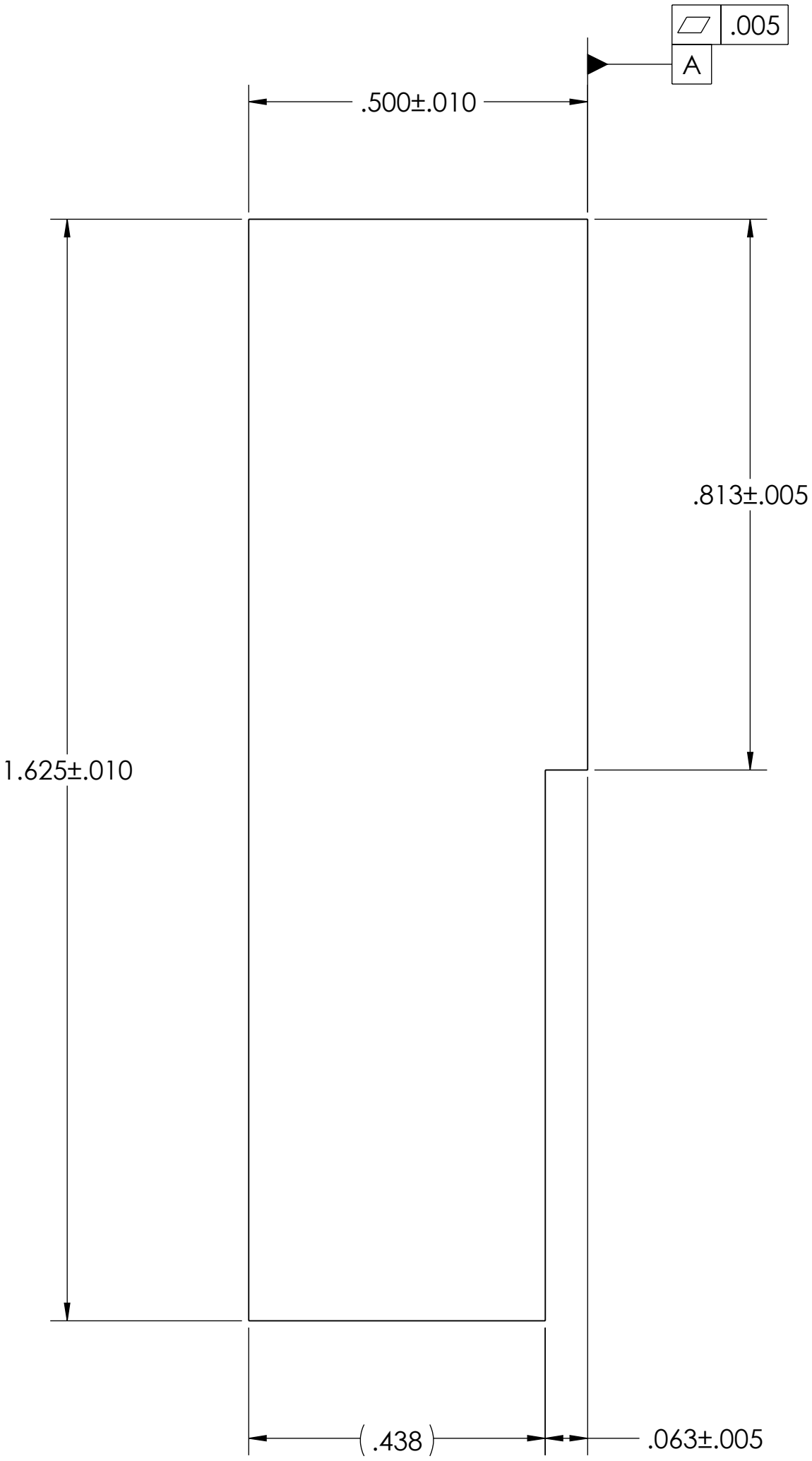
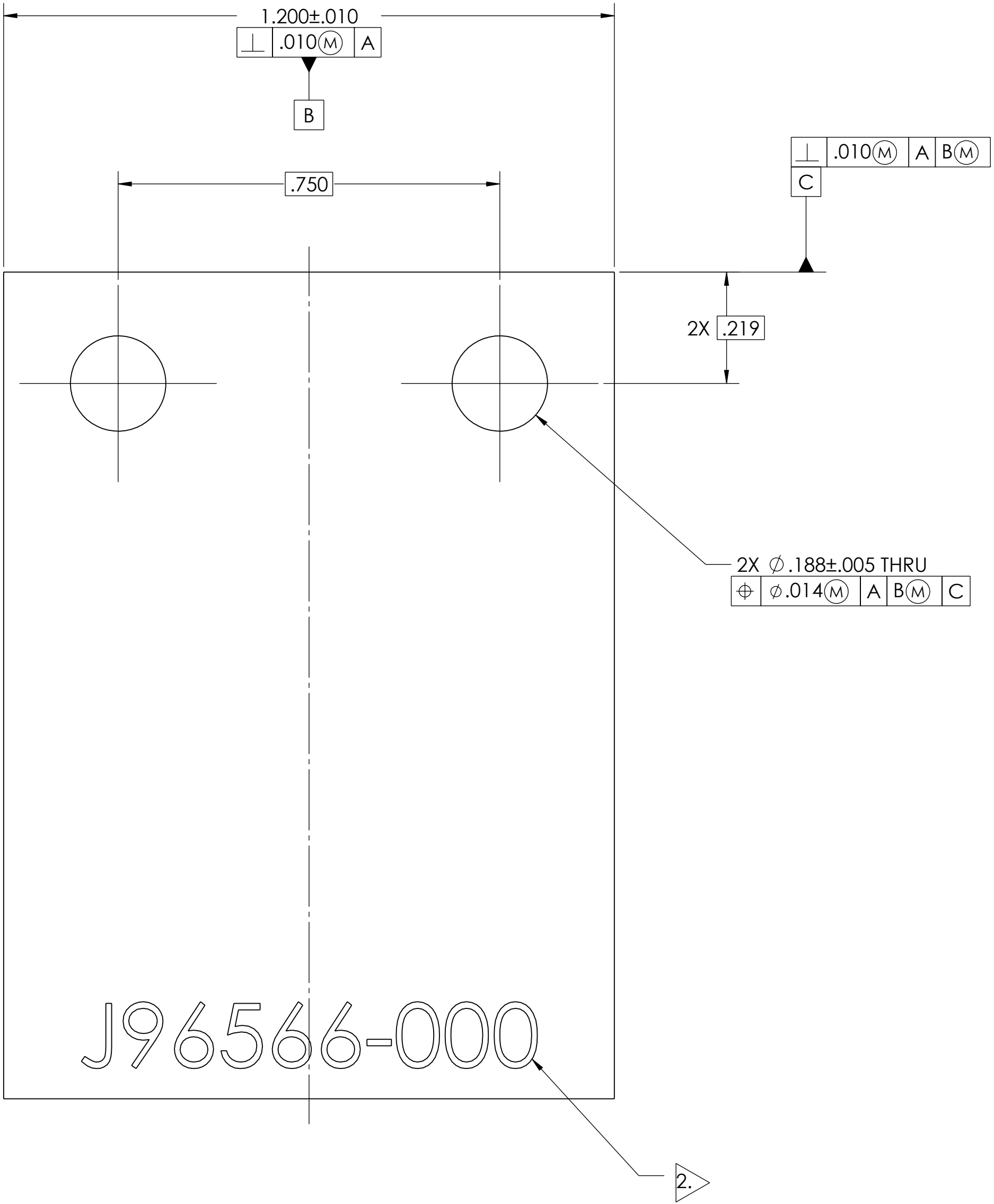
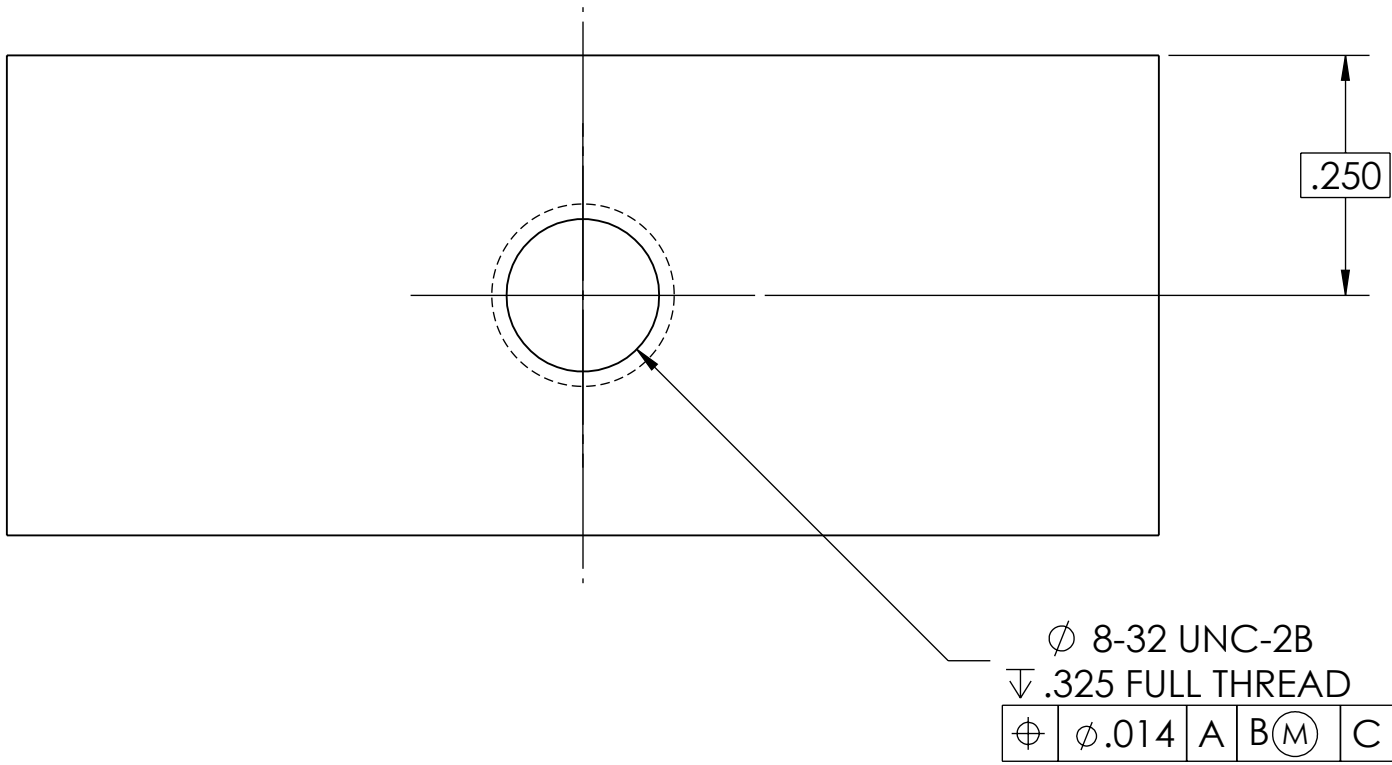

J96566-000	ENGLISH		TITLE:	
	UNCLASSIFIED		PYLON BASE, GAP	
		SIZE D	DWG. NO. J96566	REV A
	SANDIA NATIONAL LABORATORIES   10/30/2023   SHEET 1 OF 1			